

Wiring

Caution: To prevent severe shock or electrocution always turn the power OFF at the service panel before working with wiring.

Stripping the Insulation from the Wire:

Strip the insulation from the wire about 0.4 inch.

Connecting the Black and White Wires:

1. Turn the power "OFF"
2. Loosen both side screws using a flat screw-driver.
3. Insert neutral and live wire into the opening marked with N and L.
4. Tighten both side screws using the flat screw-driver.

Connecting the Green Wire:

Loop the wire clockwise 2/3 of the way around the screw.

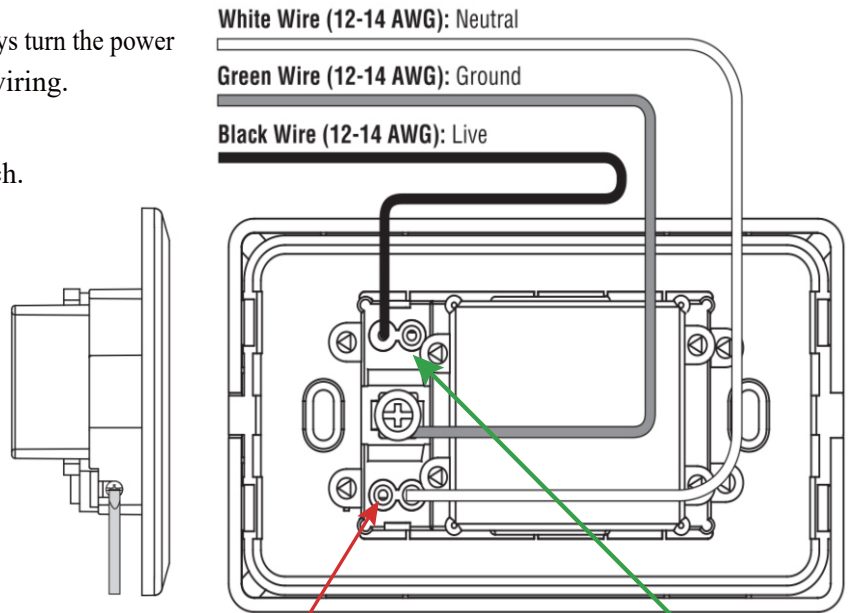

Second white wire continuing onto the next wall outlet in the circuit.

Second black wire continuing onto the next wall outlet in the circuit.

Installation

Recommended installation instructions:

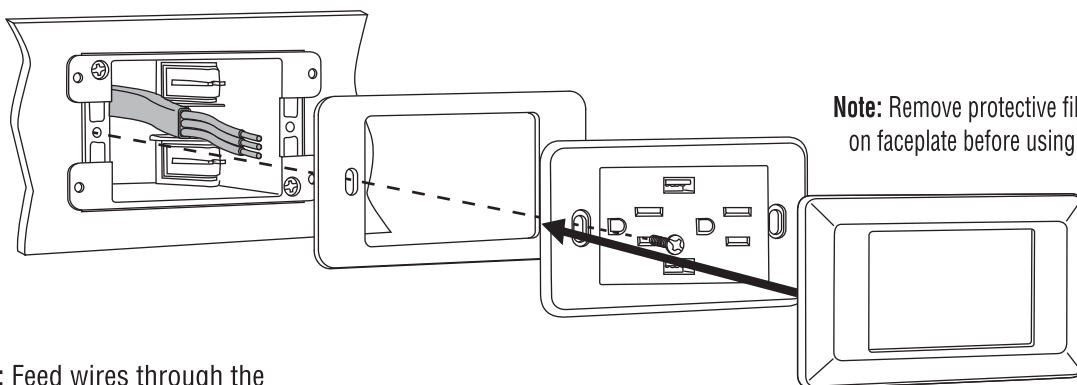

1: Feed wires through the electrical box and wire the receptacle according to the wiring instructions above.

2: Use included foam pad as necessary to reduce the faceplate gap.

3: Install the receptacle using screws to mount it to the electrical box.

4: Snap on the faceplate. Turn the power ON and check to make sure the sockets work.

Note: Remove protective film on faceplate before using.

Removal instructions:

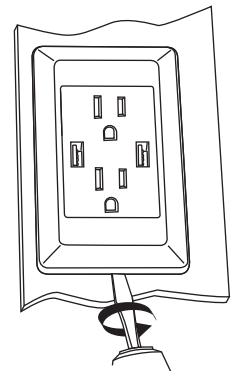

1: Insert a flat blade screw driver in one of the slots at the bottom of the faceplate.

2: Rotate the screw driver to release the faceplate from the receptacle.

Please email us with any questions or feedback you might have about our products to support@ezq.com.